



---

# CR/CF

---

## Economy Line Upright Storage Cooler & Freezer

# KEY ASPECTS

## SPECIAL FEATURES:

- Environmentally friendly hydrocarbon refrigerant
- 16 gauge steel base
- Door lock with key
- Electronic control
- Auto defrost freezer
- Grey pre-painted interior
- 304 stainless steel interior bottom

## OPTIONS:

- Extra shelves
- Casters



**CR-Complies with 2017 DOE standards for commercial cooler**  
**CF-Complies with 2017 DOE standards for commercial freezer**

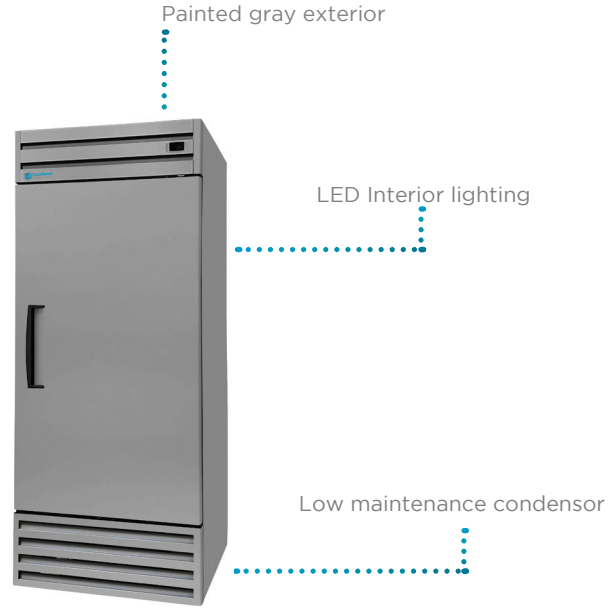

## TECHNICAL SUMMARY

MODEL	SIZE				ELECTRICAL		REFRIGERATION			OTHER	
	Dimensions (inches)* Width x Depth x Height	Cubic Feet	Net Weight (lbs.)	Shipping Weight (lbs.)**	Voltage/Hz/Phase	Running Amps	Compressor HP	Refrigerant	Temperature	Flat shelves included	Units per 40' container
CR-20HC	26 7/8 x 29 5/8 x 79 3/8	20	276	286	115/60/1	2.5	1/4	R-290	+32°F to +39°F	4	45
CR-43HC	54 5/16 x 29 5/8 x 79 7/16	43	485	507	115/60/1	4.3	1/2	R-290	+32°F to +39°F	8	24
CF-20HC	26 7/8 x 29 5/8 x 79 3/8	20	276	286	115/60/1	4.4	1/3	R-290	-5°F to +25°F	4	45
CF-43HC	54 5/16 x 29 5/8 x 79 7/16	43	485	507	115/60/1	4.7	1/2	R-290	-5°F to +25°F	8	24

\*Dimensions are all nominal lengths

\*\*Does not include weight of pallet when needed

SINGLE DOOR STORAGE FREEZER & COOLER

DOUBLE DOOR STORAGE FREEZER & COOLER

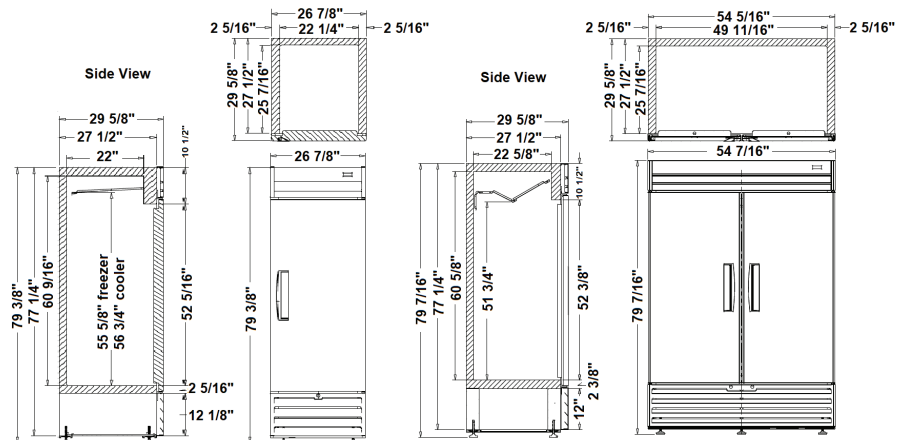

4094 Paul Buchman Highway  
 Plant City, FL 33565  
 800.441.4014 | 813.870.0340  
[www.excellenceindustries.com](http://www.excellenceindustries.com)  
 ver. 07.23