



EDC

Dipping Cabinet

KEY ASPECTS

SPECIAL FEATURES:

- Frameless lids
- 4 locking casters
- Can holders with spill guard

OPTIONS:

- Graphics
- Dipper well
- Night covers
- Locking device

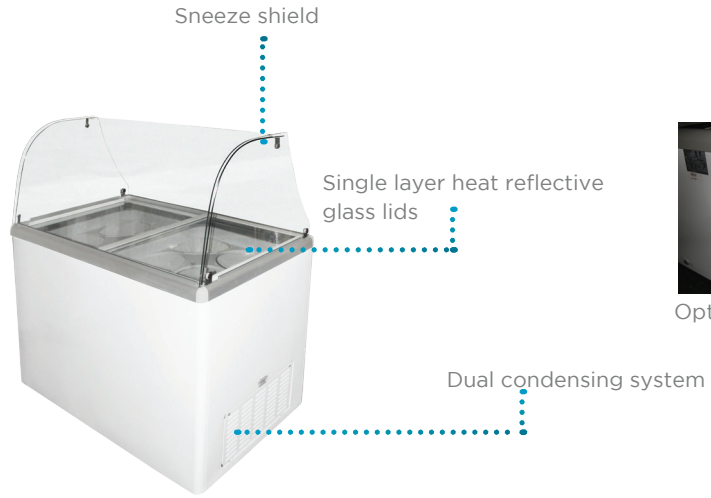

Optional dipper well



Complies with 2017 DOE standards for ice cream freezer

TECHNICAL SUMMARY

MODEL	SIZE Dimensions (inches) Width x Depth x Height	ELECTRICAL			REFRIGERATION			OTHER				
		Cubic Feet	Net Weight (lbs.)	Shipping Weight (lbs.)	Voltage/Hz/Phase	Running Amps	Max KWh/24hr	Compressor HP	Refrigerant	Temperature	3 G Tubs Displayed	Container Quantity
EDC-4HC	24 3/4 x 24 3/4 x 51 1/2	5.0	158	178	115/60/1	3.2	1.8	1/5	R-290a	-15° to +5°F	4	140
EDC-4CHC	24 3/4 x 24 3/4 x 51 1/2	5.0	158	178	115/60/1	3.2	1.8	1/5	R-290a	-15° to +5°F	4	110
EDC-8HC	47 1/2 x 24 3/4 x 51 1/2	12.5	234	258	115/60/1	4.3	2.6	1/4	R-290a	-15° to +5°F	8	72
EDC-8CHC	47 1/2 x 24 3/4 x 51 1/2	12.5	234	258	115/60/1	4.3	2.6	1/4	R-290a	-15° to +5°F	8	60

**Does not include weight of pallet when needed



SIDE VIEW
EDC 4 & 8

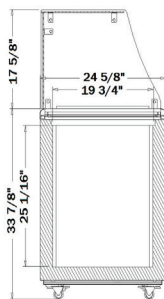

SIDE VIEW
EDC 4C & 8C

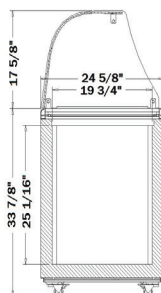

FRONT VIEW
EDC 8 & 8C

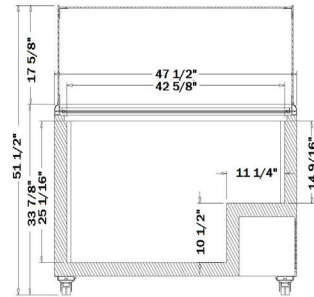

FRONT VIEW
EDC 4 & 4C

